

ROULEMENTS A BILLES BEARINGS



ROULEMENTS RIGIDES A 1 RANGEE DE BILLES DEEP GROOVE BALL BEARINGS, SINGLE ROW.

SERIES 60

REF	d	D	B	REF 2RS
6000	10	26	8	6000-2RS
6001	12	28	8	6001-2RS
6002	15	32	9	6002-2RS
6003	17	35	10	6003-2RS
6004	20	42	12	6004-2RS
6005	25	47	12	6005-2RS
6006	30	55	13	6006-2RS
6007	35	62	14	6007-2RS
6008	40	68	15	6008-2RS
6009	45	75	16	6009-2RS
6010	50	80	16	6010-2RS
6011	55	90	18	6011-2RS
6012	60	95	18	6012-2RS
6013	65	100	18	6013-2RS
6014	70	110	20	6014-2RS
6015	75	115	20	6015-2RS
6016	80	125	22	6016-2RS
6018	90	140	24	6018-2RS
6019	95	145	24	6019-2RS
6020	100	150	24	6020-2RS

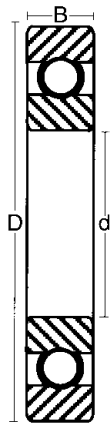

SERIES 62

REF	d	D	B	REF. 2RS
6200	10	30	9	6200-2RS
6201	12	32	10	6201-2RS
6202	15	35	11	6202-2RS
6203	17	40	12	6203-2RS
6204	20	47	14	6204-2RS
6205	25	52	15	6205-2RS
6206	30	62	16	6206-2RS
6207	35	72	17	6207-2RS
6208	40	80	18	6208-2RS
6209	45	85	19	6209-2RS
6210	50	90	20	6210-2RS
6211	55	100	21	6211-2RS
6212	60	110	22	6212-2RS
6213	65	120	23	6213-2RS
6214	70	125	24	6214-2RS
6215	75	130	25	6215-2RS
6216	80	140	26	6216-2RS
6217	85	150	28	6217-2RS

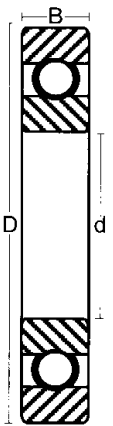

SERIES 63

REF	d	D	B	REF. 2RS
6300	10	35	11	6300-2RS
6301	12	37	12	6301-2RS
6302	15	42	13	6302-2RS
6303	17	47	14	6303-2RS
6304	20	52	15	6304-2RS
6305	25	62	17	6305-2RS
6306	30	72	19	6306-2RS
6307	35	80	21	6307-2RS
6308	40	90	23	6308-2RS
6309	45	100	25	6309-2RS
6310	50	110	27	6310-2RS
6311	55	120	29	6311-2RS
6312	60	130	31	6312-2RS
6313	65	140	33	6313-2RS
6314	70	150	35	6314-2RS

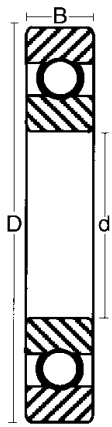

SERIES 64

REF	d	D	B
6404	20	72	19
6405	25	80	21
6406	30	90	23
6407	35	100	25
6408	40	110	27
6409	45	120	29
6410	50	130	31

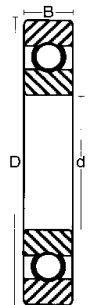

SERIES 160

REF	d	D	B
16007	35	62	9
16008	40	68	9
16009	45	75	10
16010	50	80	10
16011	55	90	11
16012	60	95	11
16013	65	100	11
16014	70	110	13
16015	75	115	13

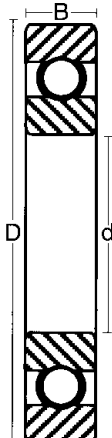

Les références des pièces sont indicatives.
Nos pièces ne sont pas d'origine.

Part numbers are quoted for reference purposes only and
are not used as original equipment.





ROULEMENTS A BILLES BEARINGS

ROULEMENTS RIGIDES A 2 RANGEES DE BILLES DEEP GROOVE BALL BEARINGS, DOUBLE ROW.

SERIES 12

REF	d	D	B	
1205	25	52	15	
1206	30	62	16	
1207	35	72	17	
1208	40	80	18	
1209	45	85	19	
1210	50	90	20	

SERIES 13

REF	d	D	B	
1304	20	52	15	
1305	25	62	17	
1306	30	72	19	
1307	35	80	21	
1308	40	90	23	
1309	45	100	25	
1310	50	110	27	

SERIES 22

REF	d	D	B	
2203	17	40	16	
2204	20	47	18	
2205	25	52	18	
2206	30	62	20	
2207	35	72	23	
2208	40	80	23	
2209	45	85	23	
2210	50	90	23	

SERIES 23

REF	d	D	B	
2303	17	47	19	
2304	20	52	21	
2305	25	62	24	
2306	30	72	27	
2307	35	80	31	
2308	40	90	33	
2309	45	100	36	
2310	50	110	40	

SERIES 32

REF	d	D	B	
3203	17	40	17,5	
3204	20	47	20,6	
3205	25	52	20,6	
3206	30	62	23,8	
3207	35	72	27,0	
3208	40	80	30,2	
3209	45	85	30,2	
3210	50	90	30,2	

SERIES 33

REF	d	D	B	
3303	17	47	22,2	
3304	20	52	22,2	
3305	25	62	25,4	
3306	30	72	30,2	
3307	35	80	34,9	
3308	40	90	36,5	
3309	45	100	39,7	
3310	50	110	44,4	

Les références des pièces sont indicatives.
Nos pièces ne sont pas d'origine.

Part numbers are quoted for reference purposes only and
are not used as original equipment.



ROULEMENTS A BILLES BEARINGS



ROULEMENTS CONIQUES A 1 RANGEE DE GALETS TAPER ROLLER BEARINGS, SINGLE ROW.

SERIES 302

REF.	d	D	B	b	T
30203	17	40	12	11	13,25
30204	20	47	14	12	15,25
30205	25	52	15	13	16,25
30206	30	62	16	14	17,25
30207	35	72	17	15	18,25
30208	40	80	18	16	19,75
30209	45	85	19	16	20,75
30210	50	90	20	17	21,75
30211	55	100	21	18	22,75
30212	60	110	22	19	23,75
30213	65	120	23	20	24,75
30214	70	125	24	21	26,75
30215	75	130	25	22	27,25
30216	80	140	26	22	28,75
30217	85	150	28	24	30,50

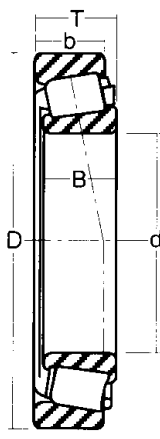

SERIES 303

REF.	d	D	B	b	T
30302	15	42	13	11	14,25
30303	17	47	14	12	15,25
30304	20	52	15	13	16,25
30305	25	62	17	15	18,25
30306	30	72	19	16	20,75
30307	35	80	21	18	22,75
30308	40	90	23	20	25,25
30309	45	100	25	22	27,25
30310	50	110	27	23	29,25
30311	55	120	29	25	31,50
30312	60	130	31	26	33,50
30313	65	140	33	28	36,00
30314	70	150	35	30	38,00
30315	75	160	37	31	40,00
30316	80	170	39	33	42,50

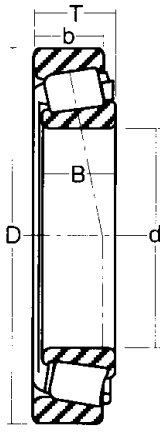

SERIES 313

REF.	d	D	B	b	T
31305	25	62	17	13	18,25
31306	30	72	19	14	20,75
31307	35	80	21	15	22,75
31308	40	90	23	17	25,25
31309	45	100	25	18	27,00
31310	50	110	27	19	29,25
31311	55	120	29	21	31,50
31313	65	140	33	23	36,00

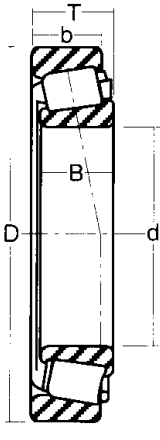

SERIES 320

REF.	d	D	B	b	T
32004	20	42	15	12	15
32005	25	47	15	11,5	15
32006	30	55	17	13	17
32007	35	62	18	14	18
32008	40	68	19	14,5	19
32009	45	75	20	15,5	20
32010	50	80	20	15,5	20
32011	55	90	23	17,5	23
32012	60	95	23	17,5	23
32013	65	100	23	17,5	23
32014	70	110	25	19	25
32015	75	115	25	19	25
32016	80	125	29	22	29
32018	90	140	32	24	32

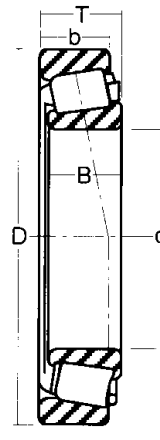

SERIES 322

REF.	d	D	B	b	T
32205	25	52	18	15	19,25
32206	30	62	20	17	21,25
32207	35	72	23	19	24,25
32208	40	80	23	19	24,75
32209	45	85	23	19	24,75
32210	50	90	23	19	24,75
32211	55	100	25	21	26,75
32212	60	110	28	24	29,75
32213	65	120	31	27	32,75
32214	70	125	31	27	33,25
32215	75	130	31	27	33,25
32216	80	140	33	28	35,25

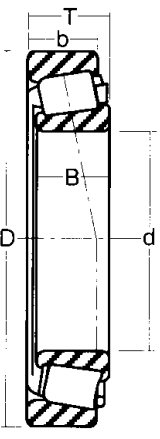

SERIES 323

REF.	d	D	B	b	T
32304	20	52	21	18	22,25
32305	25	62	24	20	25,25
32306	30	72	27	23	27,75
32307	35	80	31	25	32,75
32308	40	90	33	27	35,25
32309	45	100	36	30	38,25
32310	50	110	40	33	42,25
32311	55	120	43	35	45,50
32312	60	130	46	37	48,50
32313	65	140	48	39	51,00

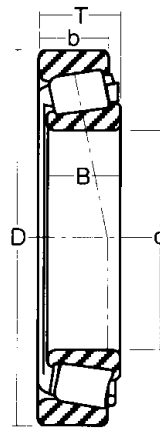

Les références des pièces sont indicatives.
Nos pièces ne sont pas d'origine.

Part numbers are quoted for reference purposes only and
are not used as original equipment.





ROUEMENTS A BILLES BEARINGS

PALIER AUTO-ALIGNEURS PLUMMER BLOCK BEARINGS

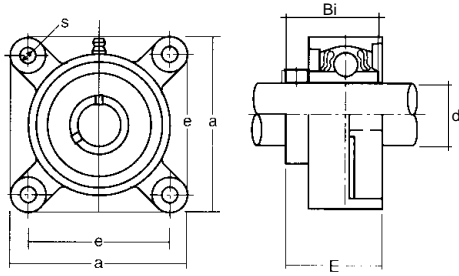

UCF SERIES 200

REF.	d	a	e	E	S	Bi
UCF 204	20	86	64	33,3	11	31,0
UCF 205	25	95	70	35,7	12	34,0
UCF 206	30	108	83	40,2	12	38,1
UCF 207	35	117	92	44,4	14	42,9
UCF 208	40	130	102	51,2	15	49,2
UCF 209	45	137	105	52,2	16	49,2
UCF 210	50	143	111	54,6	16	51,6
UCF 211	55	162	130	58,4	19	55,6
UCF 212	60	175	143	68,7	19	65,1

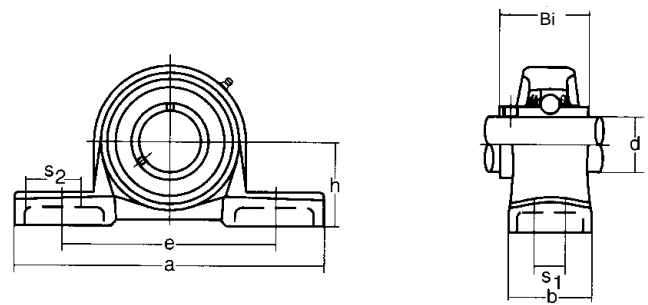

UCP SERIES 200

REF.	Ø	h	a	e	b	S1	S2	Bi
UCP 204	20	33,3	127	95	38	12	18	31,0
UCP 205	25	36,5	140	105	38	12	19	34,0
UCP 206	30	42,9	165	121	48	16	21	38,1
UCP 207	35	47,6	167	128	48	16	20	42,9
UCP 208	40	49,2	184	137	54	16	23	49,2
UCP 209	45	54,0	190	146	54	16	21	49,2
UCP 210	50	57,2	206	159	60	20	22	51,6
UCP 211	55	63,5	219	171	60	20	22	55,6
UCP 212	60	69,8	241	184	70	20	25	65,1
UCP 214	70	79,4	266	210	79,4	25	30	74,6

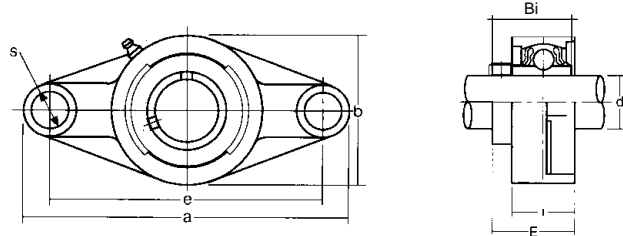

UCFL SERIES 200

REF.	d	a	e	I	E	s	b	Bi
UCFL 204	20	113	90	25,5	33,3	11	60	31,0
UCFL 205	25	122	99	30	35,7	12	68	34
UCFL 206	30	141	117	31	40,2	16	80	38,1
UCFL 207	35	156	130	34	44,4	15	90	42,9
UCFL 208	40	171	144	36	51,2	15	100	49,2
UCFL 209	45	179	148	39	52,2	19	108	49,2
UCFL 210	50	189	157	40	54,6	19	115	51,5
UCFL 211	55	216	184	43	58,4	19	130	55,6
UCFL 212	60	250	202	48	68,7	22	140	65,1

ROUEMENTS AUTO-ALIGNEURS UCF, UCFL & UCP (YAR) LOOSE BEARING

REF.	ØA	ØB	ØC
UC 204	20	47	14
UC 205	25	52	15
UC 206	30	62	19
UC 207	35	72	20
UC 208	40	80	21
UC 209	45	85	22

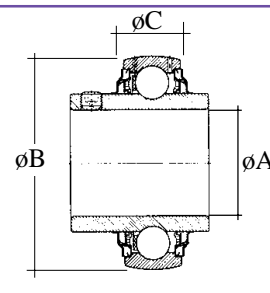

ROUEMENTS AUTO-ALIGNEURS (AVEC BAGUE EXCENTRIQUE) UCF, UCFL & UCP (YET) LOOSE BEARING (WITH EXCENTRIC LOCKING COLLAR)

REF.	AØ	ØB	ØC
SA 205	25	52	12
SA 206	30	62	14
SA 207	35	72	15
SA 208	40	80	16

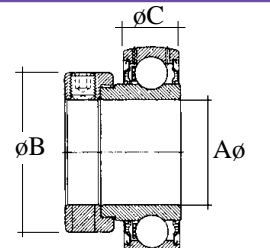

Les références des pièces sont indicatives.
Nos pièces ne sont pas d'origine.

Part numbers are quoted for reference purposes only and
are not used as original equipment.

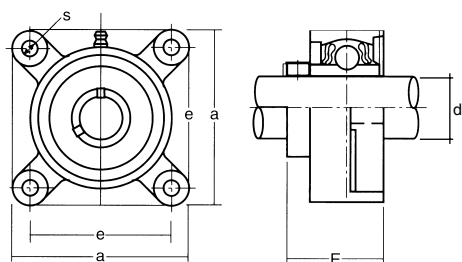

**SKF****ROULEMENTS A BILLES
KOGELLAGERS****PALERS AUTO-ALIGNEURS
Y-FLENSBLOKKEN****(FY-TF)**

REF.	d	a	e	E	S
FY20 TF	20	86	64	33,3	11
FY25 TF	25	95	70	35,7	12
FY30 TF	30	108	83	40,2	12
FY35 TF	35	117	92	44,4	14
FY40 TF	40	130	102	51,2	15
FY45 TF	45	137	105	52,2	16
FY50 TF	50	143	111	54,6	16
FY55 TF	55	162	130	58,4	19
FY60 TF	60	175	143	68,7	19
FY65 TF	65	187	149,5	76,9	18

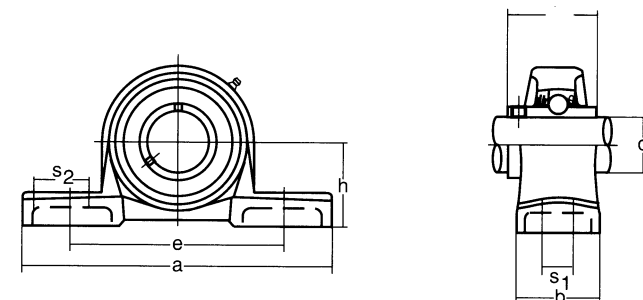
**(SY-TF)**

REF.	Ø	h	a	e	b	S1	S2
SY20 TF	20	33,3	127	95	38	12	18
SY25 TF	25	36,5	140	105	38	12	19
SY30 TF	30	42,9	165	121	48	16	21
SY35 TF	35	47,6	167	128	48	16	20
SY40 TF	40	49,2	184	137	54	16	23
SY45 TF	45	54,0	190	146	54	16	21
SY50 TF	50	57,2	206	159	60	20	22
SY55 TF	55	63,5	219	171	60	20	22
SY60 TF	60	69,8	241	184	70	20	25
SY65 TF	65	76,2	257	190	76	22	35

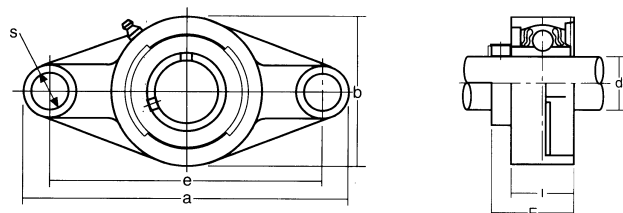
**ROULEMENTS AUTO-ALIGNEURS
UCF, UCFL & UCP
BINNENLAGERS
MET BORGBOUTBEVESTIGING****(FYTB-TF)**

REF.	d	a	e	I	E	s	b
FYTB20TF	20	113	90	25,5	33,3	11	60
FYTB25TF	25	122	99	30	35,7	12	68
FYTB30TF	30	141	117	31	40,2	16	80
FYTB35TF	35	156	130	34	44,4	15	90
FYTB40TF	40	171	144	36	51,2	15	100
FYTB45TF	45	179	148	39	52,2	19	108
FYTB50TF	50	189	157	40	54,6	19	115

REF.	ØA	ØB	ØC
YAR 204 2F	20	47	14
YAR 205 2F	25	52	15
YAR 206 2F	30	62	19
YAR 207 2F	35	72	20
YAR 208 2F	40	80	21
YAR 209 2F	45	85	22

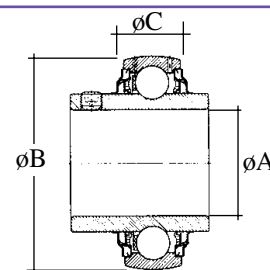
**ROULEMENTS AUTO-ALIGNEURS
(AVEC BAGUE EXCENTRIQUE)
UCF, UCFL & UCP
BINNENLAGERS MET EXCENTRERING**

REF.	AØ	ØB	ØC
YET 205	25	52	12
YET 206	30	62	14
YET 207	35	72	15
YET 208	40	80	16

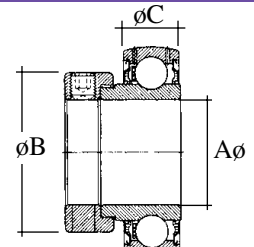

BAGUES D'ETANCHEITE

BAGUES D'ETANCHEITE
(Dimensions métriques)



Dimensions

TRA. n°

Type

Dimensions

TRA. n°

Type

6,75x1,78	FA.5120772	OR
10x18x6	FA.5105895	C
12x20x7	29/1519.042	A
17,46x28,58x6,3	FA.5110478	B
25x35x7	FA.5105887	C
28x38x7	FA.5106073	C
30x40x7	29/1510.013	A
30x42x14	FA.5135386	SP
30x47x10/7	FA.5116717	D
30x62x10	FA.5105997	C
30x72x10	FA.5119206	D
32x42x7	FA.5112294	A
34x46x10	29/1529.021	D
34x52x10/13	29/1510.216	A
35x47x7	29/1510.017	A
35x52x10	FA.44882295	A
35x55x10	29/1529.033	D
35x55x11	FA.5116701	B
35x55x12	FA.40000380	C
35x62x10	29/1510.617	A
35x62x12	29/1520.217	B
35x72x12	29/1520.317	B
36x48x10	FA.5107904	A
38x50x7	29/1510.019	A
38x52x7	29/1510.119	A
40x56x8	29/1510.120	A
40x62x10	FA.5136002	B
40x62x10	FA.40001280	D
40x62x10	FA.40002700	C
40x68x10/13	29/1529.016	D
42x56x7	29/1510.021	A
42x60x10	29/1510.221	A
42x62x17	FA.5133799	SP
42x65x12	SF.010	D
45x62x10	FA.44882502	A
45x62x10	29/1520.023	B
45x62x10	29/1529.036	B
45x62x16	29/1529.078	SP
45x65x10	FA.40000370	C
45x65x10	29/1529.031	C
45x65x15	FA.5135990	SP
45x72x10	FA.5109074	D
45x75x10/8	FA.5106065	C
45x85x10	FA.5123299	C
48x62x8	29/1510.025	A
48x65x10	FA.5107816	A
50x62x7	FA.5105932	B
50x68x8	FA.5106069	C
50x68x10	29/1520.026	B
50x72x10/8	29/1510.426	A
50x72x10	29/1529.041	D
50x80x8	FA.5119215	C
50x80x10	FA.5106867	C
53x68x10	FA.5107908	C
54x72x10	FA.44881977	B
55x70x8	FA.5105903	D
55x72x10	FA.4589556	A
55x72x10	FA.40000440	A
55x72x12	29/1529.032	D
55x75x13	FA.44014376	A
55x76x12	FA.44882107	B

55x80x10	SF.590737	B
55x80x10	FA.5119203	B
55x80x10	29/1529.022	D
55x85x8	FA.5105899	C
55x90x10	FA.5129003	B
56x70x8	FA.5105969	B
57x85x12	FA.5111415	D
58x80x10	29/1519.010	B
58x80x10	29/1520.130	B
60x75x8	29/1520.131	B
60x80x10	29/1520.231	B
60x80x12	FA.44881191	A
65x85x10	29/1510.331	A
60x90x10	FA.40002550	C
60x90x13	FA.40001260	D
65x85x12	FA.40000140	A
65x90x10	FA.5107812	A
65x90x12	FA.44881932	A
68x90x10	FA.5112290	D
70x85x8	29/1510.036	A
70x90x10/12	29/1529.004	D
70x90x12/95	29/1529.072	B
70x97,7x19	FA.5136174	SP
70x100x10	29/1520.336	B
70x100x12	29/1529.026	D
75x90x7	FA.40000420	C
75x100x10	FA.5119566	B
75x100x17	SF.8831405	D
80x100x10/13	29/1520.141	B
80x100x13	FA.5107903	A
80x110x12	FA.5119262	D
80x110x16	FA.5123370	SP
85x110x12	29/1529.501	B
85x110x16	FA.5131916	SP
90x120x13	FA.5135387	SP
95x120x13	SF.0720	D
95x120x13	29/1510.447	A
98x120x13	29/1519.009	SP
100x120x12	29/1520.049	B
100x125x12	29/1529.013	A
100x130x16	FA.5123205	SP
105x125x16	FA.5136004	SP
110x130x12	FA.5105973	C
110x130x13	29/1529.073	D
110x135x13	SF.011	D
110x140x13	29/1529.056	D
110x150x16	FA.5123259	SP
112x140x13	FA.5112298	D
114x135x13	SF.1800	D
125x150x13	FA.5107808	D
125x150x13	29/1529.040	D
125x150x15	SF.02650	D
130x160x12	29/1510.055	A
130x170x12	FA.5112286	D
135x160x15	29/1529.023	D
145x170x13	29/1529.038	D
145x180x15	29/1529.064	D
150x180x15	29/1529.065	D
165x190x17	FA.5137109	SP
180x205x23	29/1529.081	SP
240x270x25	29/1529.069	SP

A = Extérieur souple/simple lèvres
B = Extérieur souple/double lèvres

C = Extérieur métal/simple lèvres
D = Extérieur métal/double lèvres

SP = Exécution spécial protection
OR = "O" ring

"Un service sûr"